

Porca Castelo sem Coroa Polegada

Dímetro (d) mm Pol.	Rosca / FPP	Altura (h) mm	Chave (S) mm Pol. / mm	Peso ct/100pçs
1/2"	UNF 20	11,38	3/4 - 19,05	1,340
9/16"	UNF 18	12,60	7/8 - 22,22	2,108
5/8"	UNF 18	14,20	15/16 - 23,81	2,602
3/4"	UNF 16	16,89	1 1/8 - 28,57	4,065
7/8"	UNF 14	19,71	1 5/16 - 33,33	7,190
1"	UNS 14	22,53	1 1/2 - 38,10	10,225
1"	UNF 12	22,53	1 1/2 - 38,10	10,225
1 1/8"	UNF 12	25,37	1 5/8 - 41,27	13,135
1 1/4"	UNF 12	27,78	1 7/8 - 47,62	20,060
1 3/8"	UNF 12	30,63	2 - 50,80	28,185
1 1/2"	UNF 12	33,45	2 1/4 - 57,15	36,310

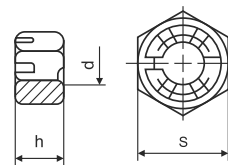

Unidade de Venda: Kg/CT